

# NIKY and NIKY S

UPS  
SINGLE-PHASE  
from 600 to 3000 VA



GLOBAL SPECIALIST IN ELECTRICAL  
AND DIGITAL BUILDING INFRASTRUCTURES





# Niky S

## line interactive

- Sinusoidal output
- Microprocessor control
- MODEM/LAN telephone protection
- RS-232 or USB interface
- Cold start function
- Protection against voltage peaks
- Integrated self-diagnostics
- Intelligent battery management
- Overload and short-circuit protection
- Excellent voltage regulation

Ideal protection  
for small office  
and home office  
applications

This range offers the best quality/price ratio for the safety of data in the office or the home.

Microprocessor controlled and with an electronic automatic voltage regulator (AVR) and an intelligent communication interface, they provide optimum protection management.



# Niky

line interactive

Advanced management according to battery discharge level  
AVR (automatic voltage regulator)  
Integrated self-diagnostics  
Cold start function  
Microprocessor control  
RS232 or USB interface  
MODEM/LAN telephone protection

# Niky

## Line Interactive UPS - Single phase VI



3 100 02

3 100 13

Pack	Cat. Nos.	UPS WITH GERMAN STANDARD OUTPUT SOCKETS					
		NOMINAL POWER (VA)	ACTIVE POWER (W)	BACKUP TIME (min)	NO. OF IEC SOCKETS	NO. OF GERMAN STANDARD SOCKETS	COMMUNIC. PORTS
	<b>3 100 00</b>	600	300	3 to 30	-	1	USB
	<b>3 100 01</b>	800	400	3 to 30	-	1	USB

	Cat. Nos.	UPS WITH GERMAN STANDARD OUTPUT SOCKETS + IEC SOCKET					
		NOMINAL POWER (VA)	ACTIVE POWER (W)	BACKUP TIME (min)	NO. OF IEC SOCKETS	NO. OF GERMAN STANDARD SOCKETS	COMMUNIC. PORTS
	<b>3 100 09</b>	600	300	5 to 30	1	1	USB
	<b>3 100 10</b>	800	400	5 to 30	1	1	USB
	<b>3 100 13</b>	1000	600	5 to 30	2	2	RS232
	<b>3 100 14</b>	1500	900	5 to 30	2	2	RS232

	Cat. Nos.	UPS WITH IEC MULTI-SOCKET OUTLETS					
		NOMINAL POWER (VA)	ACTIVE POWER (W)	BACKUP TIME (min)	NO. OF IEC SOCKETS	NO. OF GERMAN STANDARD SOCKETS	COMMUNIC. PORTS
	<b>3 100 02</b>	600	300	5 to 30	3	-	USB
	<b>3 100 03</b>	800	400	5 to 30	3	-	USB
	<b>3 100 04</b>	1000	600	5 to 30	6	-	USB
	<b>3 100 05</b>	1500	900	5 to 30	6	-	USB

	Cat. Nos.	UPS WITH FRENCH BELGIUM STANDARD SOCKET+ IEC SOCKET					
		NOMINAL POWER (VA)	ACTIVE POWER (W)	BACKUP TIME (min)	NO. OF IEC SOCKETS	NO. OF FRENCH BELGIUM STANDARD SOCKET	COMMUNIC. PORTS
	<b>3 100 22</b>	600	300	5 to 30	1	1	USB
	<b>3 100 23</b>	800	400	5 to 30	1	1	USB
	<b>3 100 26</b>	1000	600	5 to 30	2	2	RS232
	<b>3 100 27</b>	1500	900	5 to 30	2	2	RS232

Cat. Nos.	3 100 00*	3 100 01*	3 100 04	3 100 05
	3 100 02	3 100 03	3 100 13	3 100 14
	3 100 09	3 100 10	3 100 26	3 100 27
	3 100 22	3 100 23		

General characteristics				
Nominal power (VA)	600	800	1000	1500
Active power (W)	300	400	600	900
Technology	Line interactive VI			
Waveform	Pseudo-sinusoidal			

Input characteristics	
Input voltage	230 V
Input frequency	50-60 Hz +/-5Hz
Input voltage range	160 V-290 V

Output characteristics	
Output voltage	230 V ± 10%
Output frequency (nominal)	50/60 Hz +/-1%
THD of output voltage	< 3% with linear load

Batteries				
Number of batteries	1	1	2	2
Battery range type/voltage	12 V, 7 Ah	12 V, 9 Ah	12 V, 7 Ah	12 V, 9 Ah

Communication and management		
Screen and signalling	One button and 2 LEDs for real-time control	One button and 4 LEDs for real-time control
Telephone protection	RJ 11/RJ 45	
Remote control	Available	

Mechanical characteristics			
Dimensions H x W x D (mm)	171x95x349	239x147x354	
Net weight (kg)	7	7.5	13

Ambient conditions	
Ambient operating temperature (°C)	0 to 40°C
Relative humidity (%)	0 to 95%
Noise at 1 m (dBA)	< 40

Certifications	
Reference product standards	EN 62040-1, EN 62040-2, EN 62040-3

\* 3 100 00 battery 12V5Ah, 3 100 01 battery 12V 7Ah

NOTE: The backup times, expressed in minutes, are measured under optimum operating conditions.

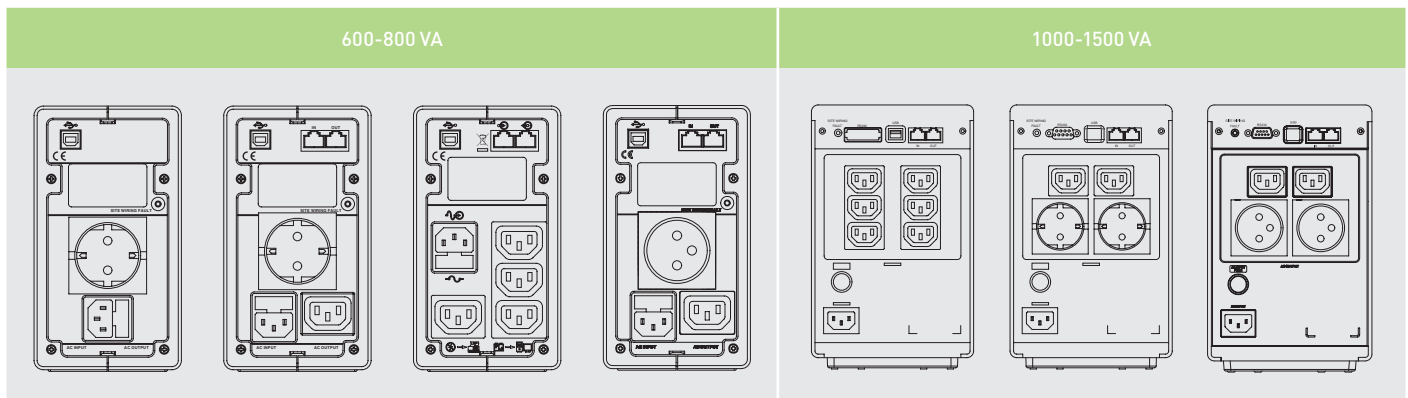

# Niky S

## Line Interactive UPS - Single phase VI-SS



3 100 06

Pack	Cat. Nos.	UPS	NOMINAL POWER VA	ACTIVE POWER W	BACKUP TIME (min)	NO. OF SOCKETS IEC	COMMUNICATION PORTS
	<b>3 100 06</b>		1000	600	9	6	USB-RS 232
	<b>3 100 20</b>		1500	900	8	6	USB-RS 232
	<b>3 100 07</b>		2000	1200	9	6	USB-RS 232
	<b>3 100 08</b>		3000	1800	8	6	USB-RS 232

Cat. Nos.	3 100 06	3 100 20	3 100 07	3 100 08
<b>General characteristics</b>				
Nominal power (VA)	1000	1500	2000	3000
Active power (W)	600	900	1200	1800
Technology	Line interactive VI-SS			
Waveform	Sinusoidal			
<b>Input characteristics</b>				
Input voltage	230 V ± 12% via mains ± 5% via battery			
Input frequency	50-60 Hz +/-3Hz			
Input voltage range	160 V-290 V			
<b>Output characteristics</b>				
Output voltage	230 V ± 10%			
Output frequency (nominal)	50/60 Hz +/-0.2%			
THD of output voltage	< 3% with linear load			
<b>Batteries</b>				
Number of batteries	2	2	4	4
Battery range type/voltage	12 V, 7 Ah	12 V, 9 Ah	12 V, 7 Ah	12 V, 9 Ah
<b>Communication and management</b>				
Screen and signalling	Three buttons and three LEDs for real-time control of the status of the UPS			
Telephone protection	RJ 11/RJ 45			
Remote control	Available			
<b>Mechanical characteristics</b>				
Dimensions H x W x D (mm)	247x173x369		247x173x465	
Net weight (kg)	13	15	22	24
<b>Ambient conditions</b>				
Ambient operating temperature [°C]	0 to 40°C			
Relative humidity [%]	0 to 95% non-condensing			
Noise at 1 m (dBA)	< 40			
<b>Certifications</b>				
Reference product standards	EN 62040-1, EN 62040-2, EN 62040-3			

**NOTE:** The backup times, expressed in minutes, are measured under optimum operating conditions.

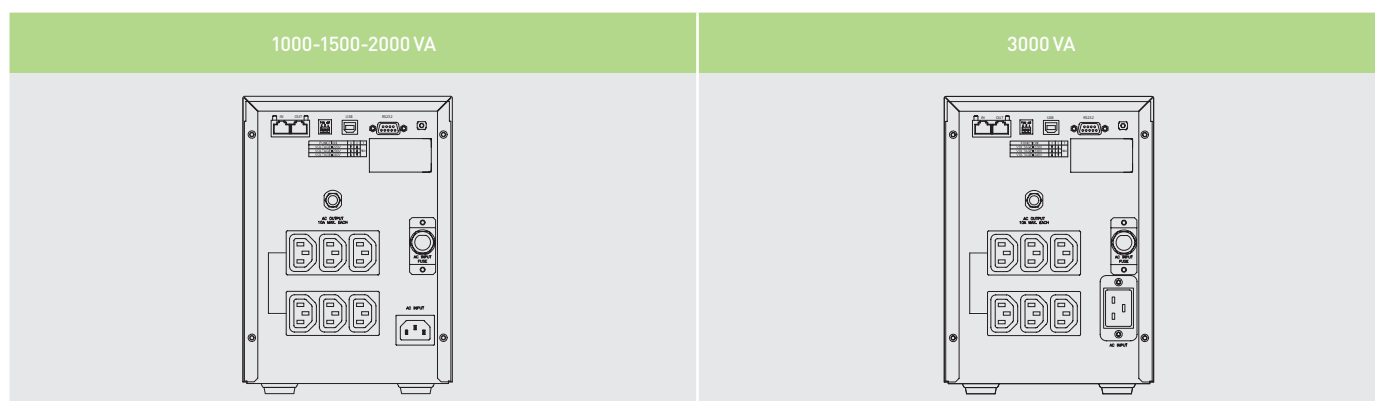



**World Headquarters and  
International Department**  
87045 Limoges Cedex - France  
☎ : + 33 (0) 5 55 06 87 87  
Fax : + 33 (0) 5 55 06 74 55

---

In accordance with its policy  
of continuous improvement, the  
Company reserves the right to change  
specifications and designs without  
notice. All illustrations, descriptions,  
dimensions and weights in this  
catalogue are for guidance and cannot  
be held binding on the Company.